



CITY OF REDMOND

ENGINEERING DEPARTMENT

The City has completed the SW 27th Street Improvement project. A major component of the project was the new intersection and traffic signal at Highway 126/ SW Highland Avenue. This intersection provides an improved and safer access to SW Highland Avenue and Highway 126 from the neighborhoods north and south of the highway.

The City's grant of access from the Oregon Department of Transportation (ODOT) for the new signalized intersection at SW 27th Street required that the City make changes to the intersection at SW 23rd Street to improve pedestrian and traffic safety. The intersection at 23rd Street has been used as the primary access onto the state highway for many years and is frequently used by high school students crossing to the Nolan Town Center. Left turns from 23rd Street on to the highway can be difficult due to the volume of highway traffic and the combination of traffic delays and pedestrian crossings creates an unsafe situation.

To improve traffic and pedestrian safety, the City is scheduled to make the crossing improvements beginning August 17, 2009. The four corners will be reconstructed with accessible pedestrian ramps and pedestrian crossing warning signs. A center median island will be constructed to improve pedestrian safety, prevent 23rd street traffic from crossing Highland and prohibit left turns from the highway and SW 23rd Street. Right turns onto or from Highland Ave. (Highway 126) at SW 23rd Street will be allowed. We encourage motorists to use the signalized intersections at SW 27th Street or SW Rimrock Way for access to SW Highland Ave and Highway 126 to the west.

Completion of the improvements are scheduled for September 7, 2009

If there are any questions regarding the proposed construction, please call the Engineering office at 504-2002.

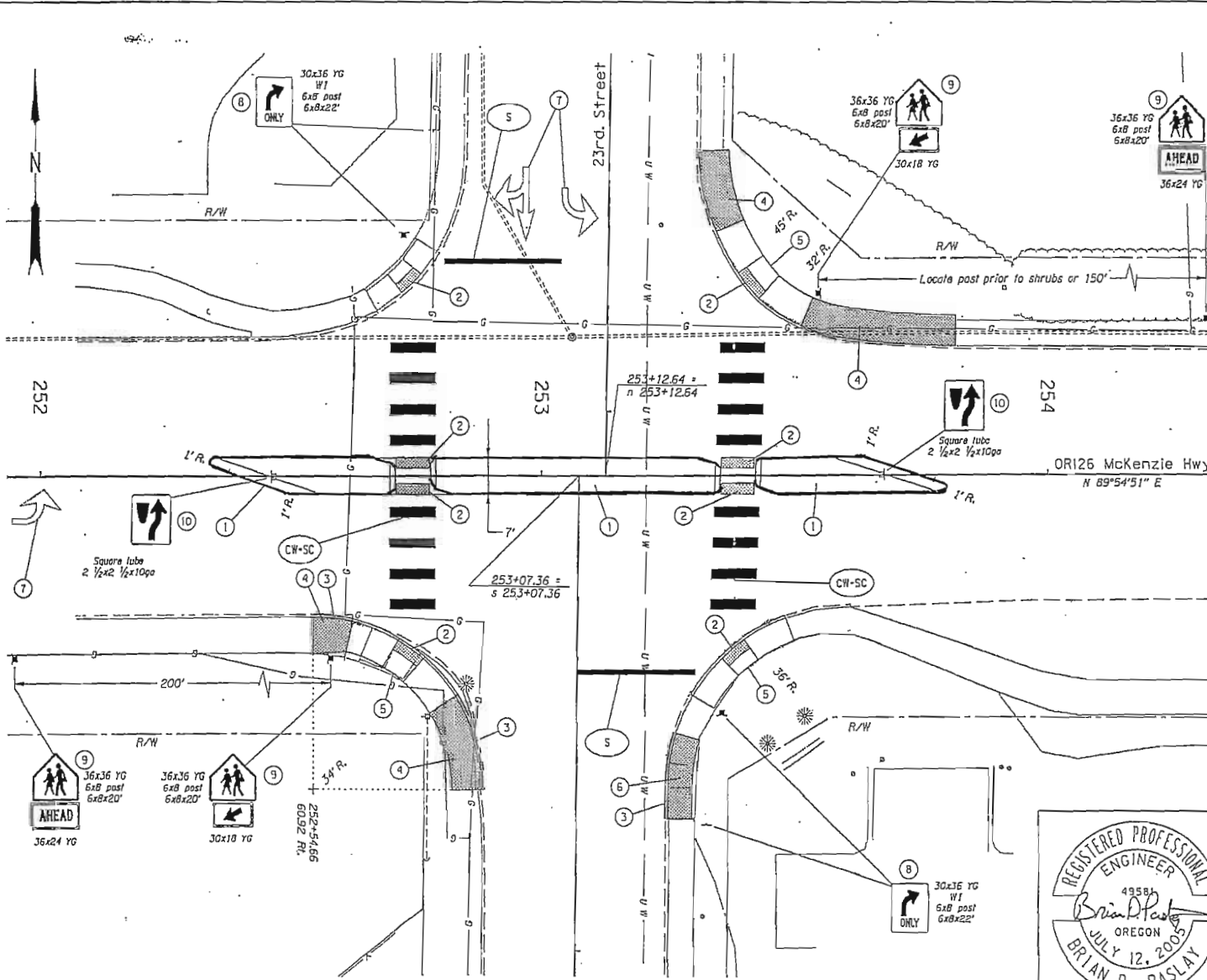

- APPROVED DESIGN**
INFORMATION ONLY
REVISED STANDARDS
2004-07
- 1 Sta. 252+34 to Sta. 253+80
Const. "Type C" stamped conc.
non-mountable island
(See drg. no. RD705)
See Sht. 2B for Details
 - 2 Const. truncated dome detectable warning surface - 8
(See drg. no. RD710 & RD759)
 - 3 Const. curb as directed
(See drg. no. RD700)
 - 4 Const. sidewalk
(See drg. no. RD720)
 - 5 Const. sidewalk ramp (Opton K)
(See drg. no. RD757)
 - 6 Remove extg. ramp & replace w/sidewalk to match extg.
 - 7 Remove lagand
 - 8 Remove all signs & post. Inst. all extg. signs plus
new W1 on new 6x8 post.
 - 9 Inst. new signs on wood post
 - 10 Inst. new signs on square tube support
(See drg. no. TM681)
- 5 Inst. 12" white stop bar
- CW-SC Inst. staggered continental crosswalk

REGISTERED PROFESSIONAL
ENGINEER
49584
Brian D. Paslay
OREGON
JULY 12, 2005
BRIAN D. PASLAY
RENEWS: 12-31-2010

OREGON DEPARTMENT OF TRANSPORTATION	
REGION 4 TECHNICAL CENTER	
OR126: 23RD STREET PROJECT MCKENZIE HIGHWAY DESCHUTES COUNTY	
Designed By - Brian D. Paslay Drafted By - Joseph J. Rodriguez	
GENERAL CONSTRUCTION	SHEET NO. 3